

1

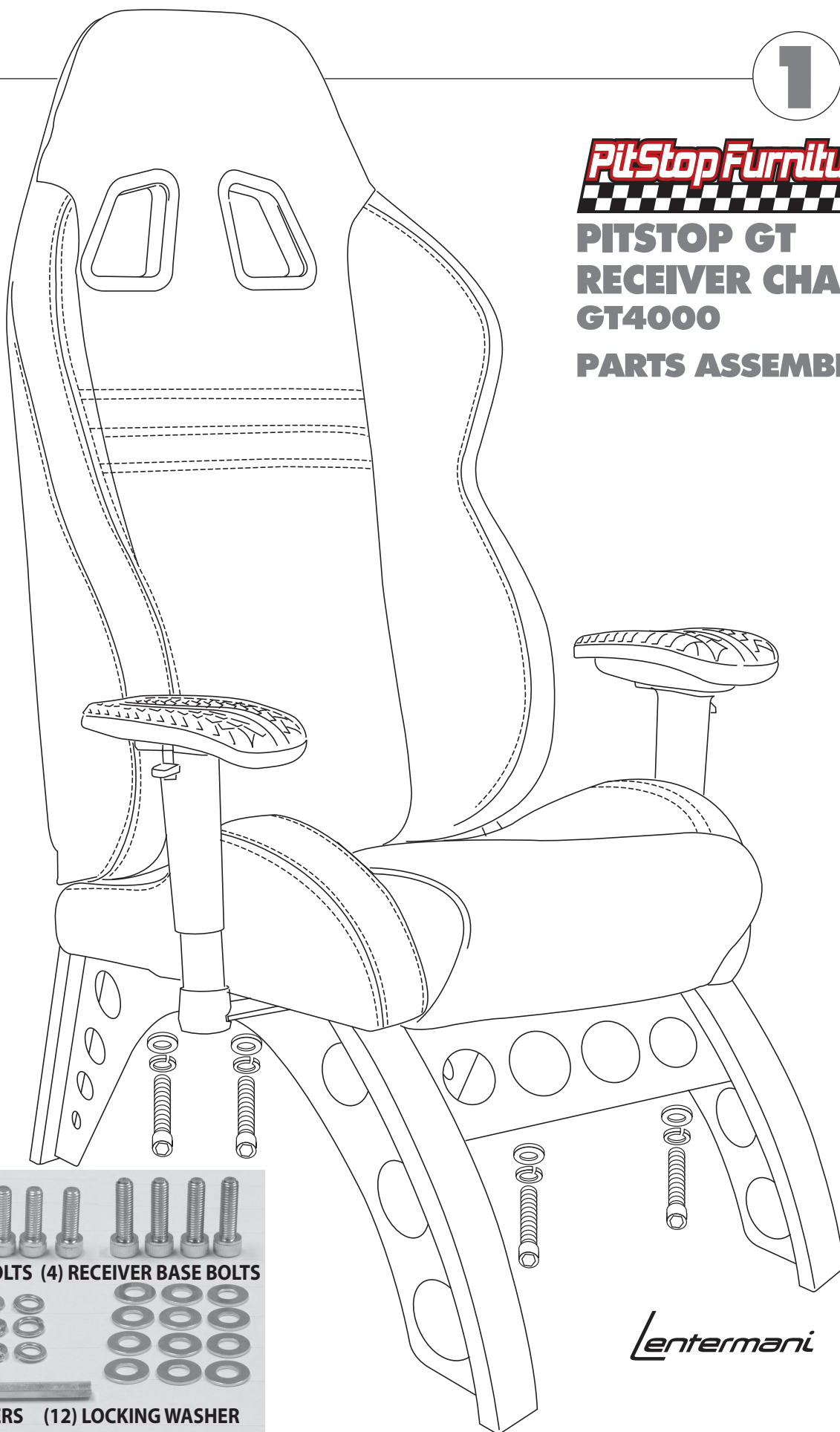

PITSTOP GT RECEIVER CHAIR GT4000

PARTS ASSEMBLY



Lentermani

2

PITSTOP GT RECEIVER CHAIR PARTS ASSEMBLY

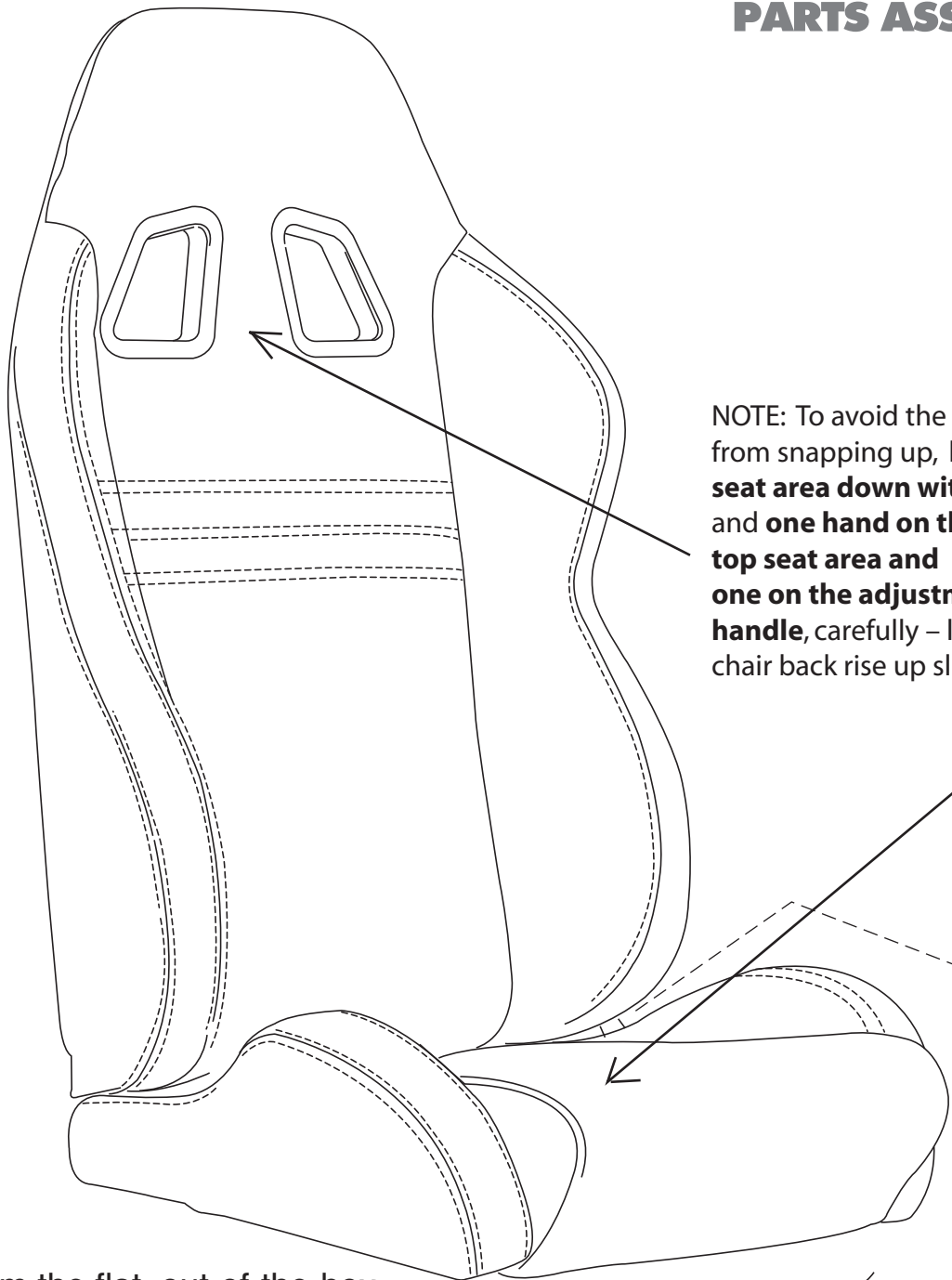

NOTE: To avoid the chair from snapping up, **hold the seat area down with your knee**, and **one hand on the top seat area and one on the adjustment handle**, carefully – let the chair back rise up slowly.

From the flat, out-of-the-box position – carefully lift up the right seat adjustment handle to an upright position (approximately 90° angle) start your racing chair assembly

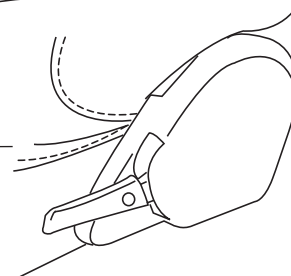

**PITSTOP GT
RECEIVER CHAIR
PARTS ASSEMBLY**

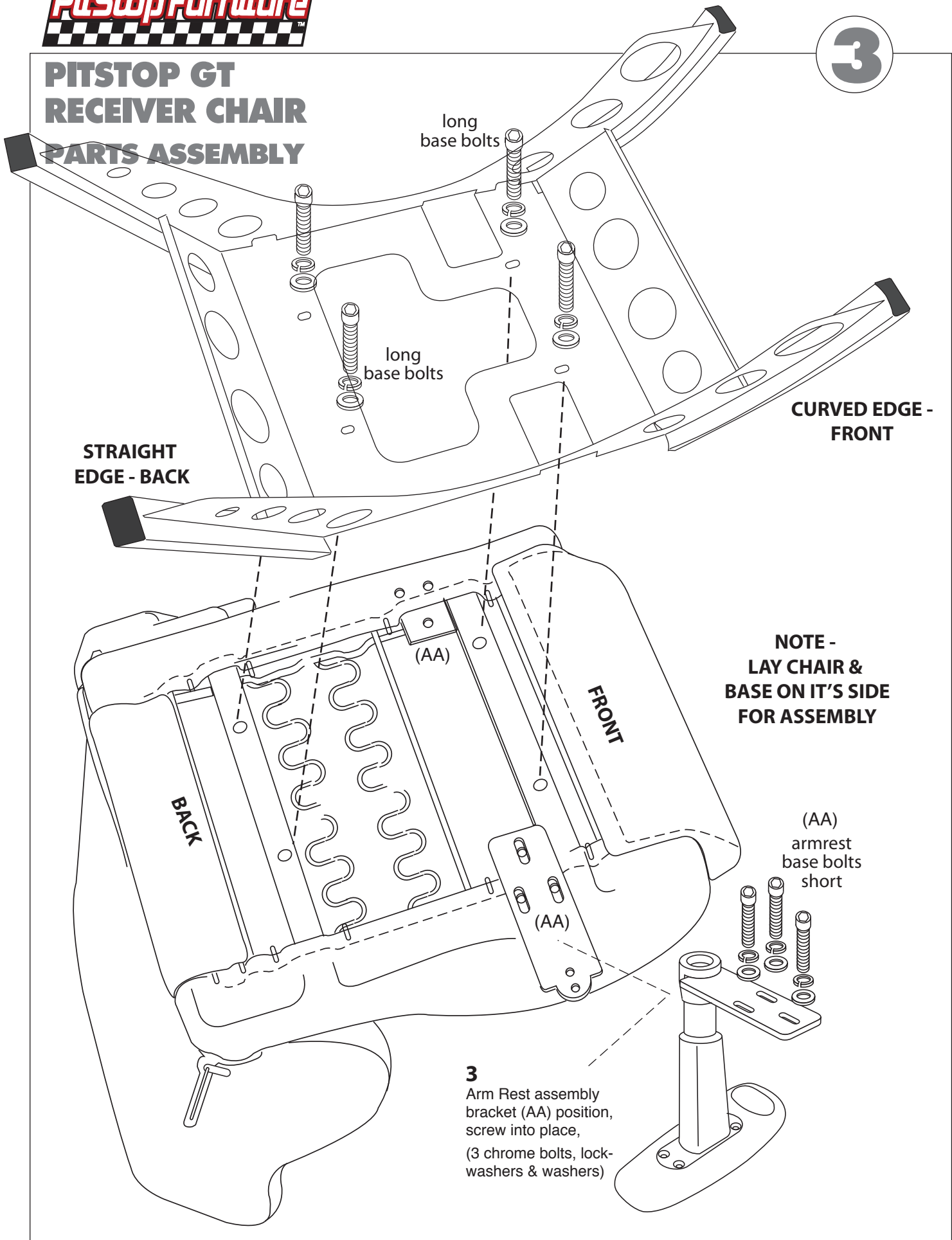

4



PITSTOP GT RECEIVER CHAIR PARTS ASSEMBLY

Arm Rest – Three adjustable height settings

Lift each arm rest up and let it drop to bottom position, **carefully** lift up to desired height setting (3 settings – high, medium, low)

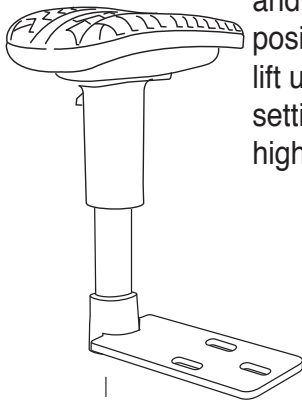

(AA)

STRAIGHT EDGE
BACK

short bucket
bolts - base

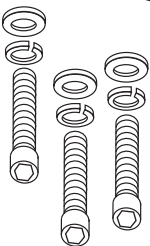

CURVED EDGE
FRONT

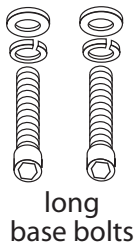
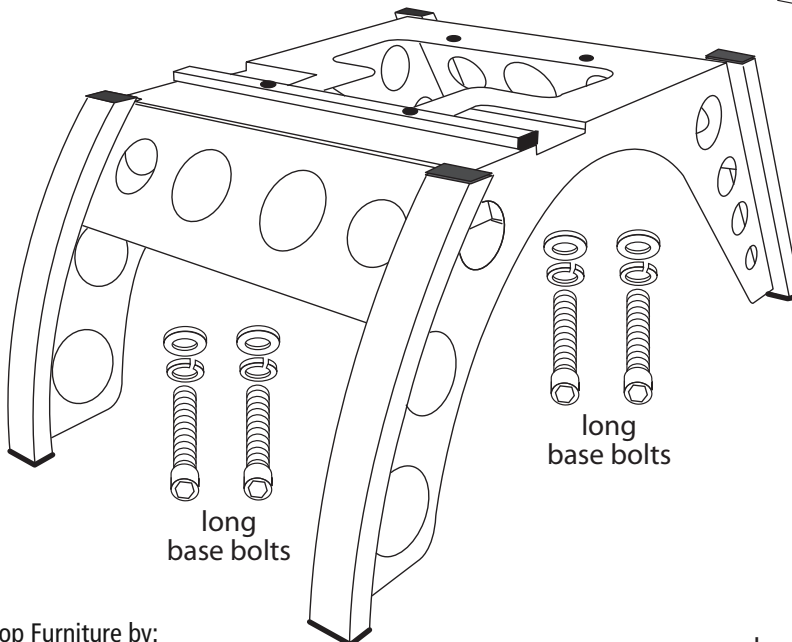

long
base bolts

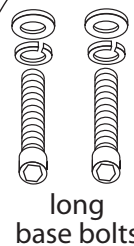

long
base bolts

STRAIGHT EDGE
BACK

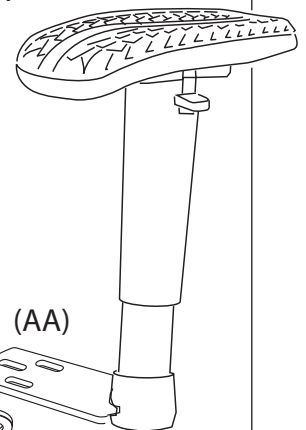

(AA)

short bucket
bolts - base



PitStop Furniture by:
Intro-Tech Automotive, Inc., Chino, California 91710
www.intro-techautomotive.com

© 2014 Intro-Tech Automotive, Inc. All rights reserved