

Storage Wall Shelves Item No. WR26/WR26B Installation Guide

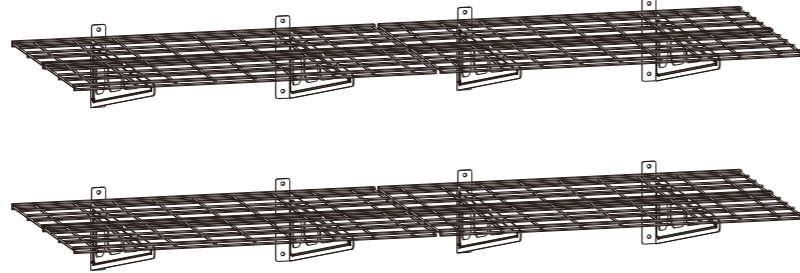

Package Included:

(A) Parts Included:

Shelf Brackets
Left Side (4 pcs)

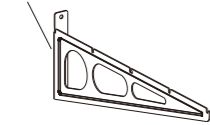

Shelf Brackets
Right Side (4 pcs)

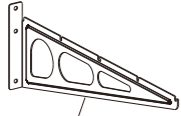

Velcro (16 pcs)



1' x 3'
Wire Grids
(8 pcs)

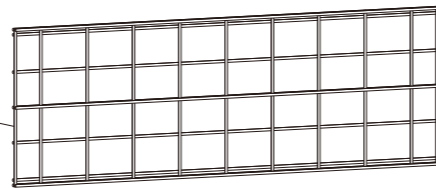

Installation
Template
(1 pc)

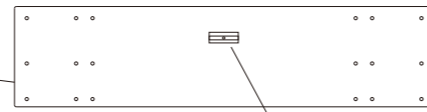

Level
(1 pc)

(B) Screw Package B (4 packs)

Each contains:

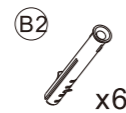
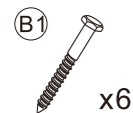

(C) Tools Needed for Assembly:

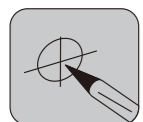

Pencil

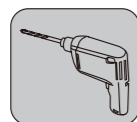

Power Drill

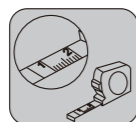

Tape Measure

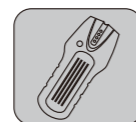

Stud/Joist Finder



Ladder



Eye Protection



Wrench

Installation Steps:

STEP 1-A: Install Shelf Brackets into Wall Studs

Use a stud-finder to locate studs.

1. Decide the height and use template and level to mark the holes (The template is designed for studs 16", 18" and 24" apart). Make sure hole locations are level before drilling holes.
2. Drill 60mm deep holes with 3/16" drill bit.
3. Install the shelf brackets with washers (B3) and lag screws (B1) with wrench.

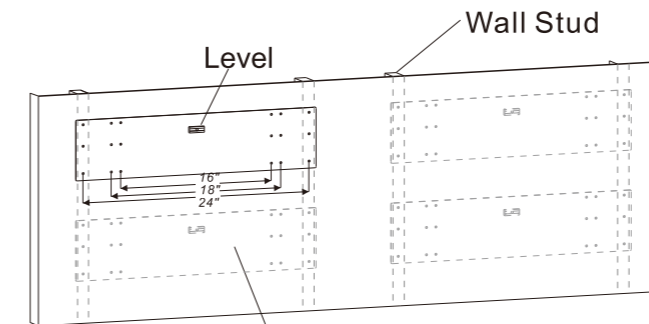
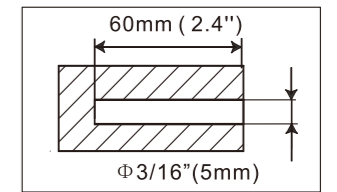

Installation Template

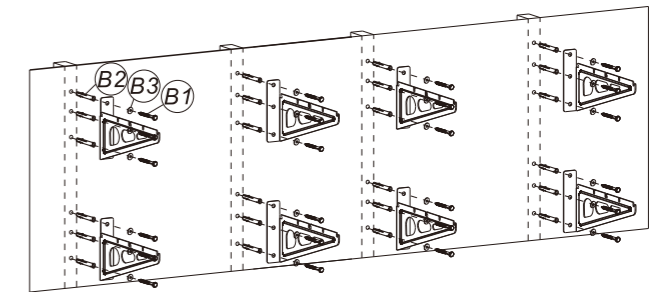
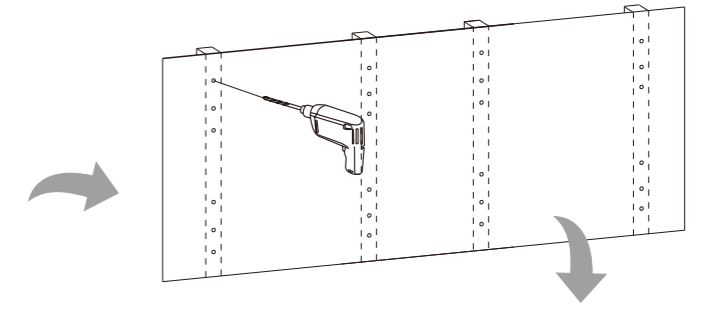
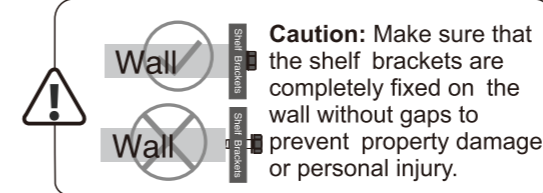

STEP 1-B: Install Shelf Brackets into Solid Concrete Wall

1. Decide the height and use template and level to mark the hole. Make sure hole locations are level before drilling holes.
2. Drill 60mm deep holes with 3/8" drill bit.
3. Screw in the metal expansion bolts (B2) firstly and then install the shelf brackets with washers (B3) and lag screws (B1) with wrench.

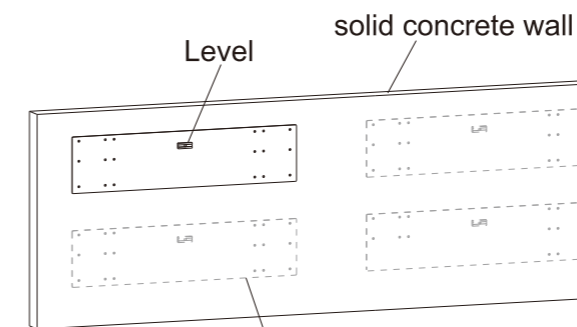
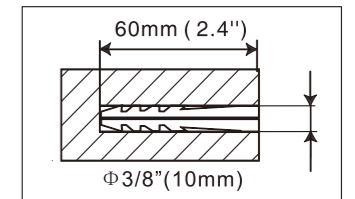

Installation Template

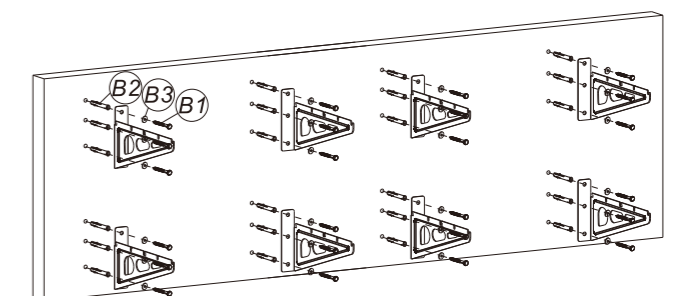
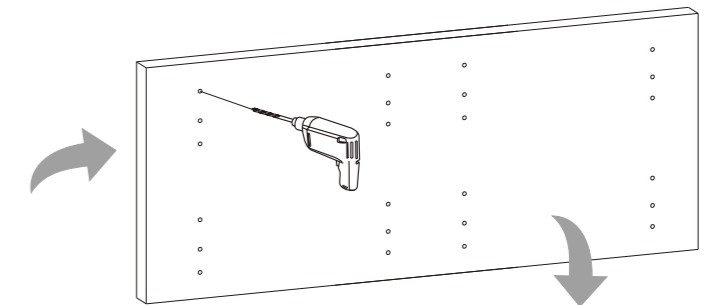
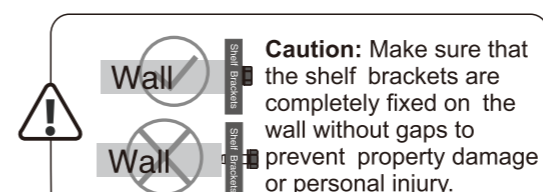

STEP 2: Place and Attach Wire Grids

1. As figure shown, buckle the wire grids on to the shelf brackets.

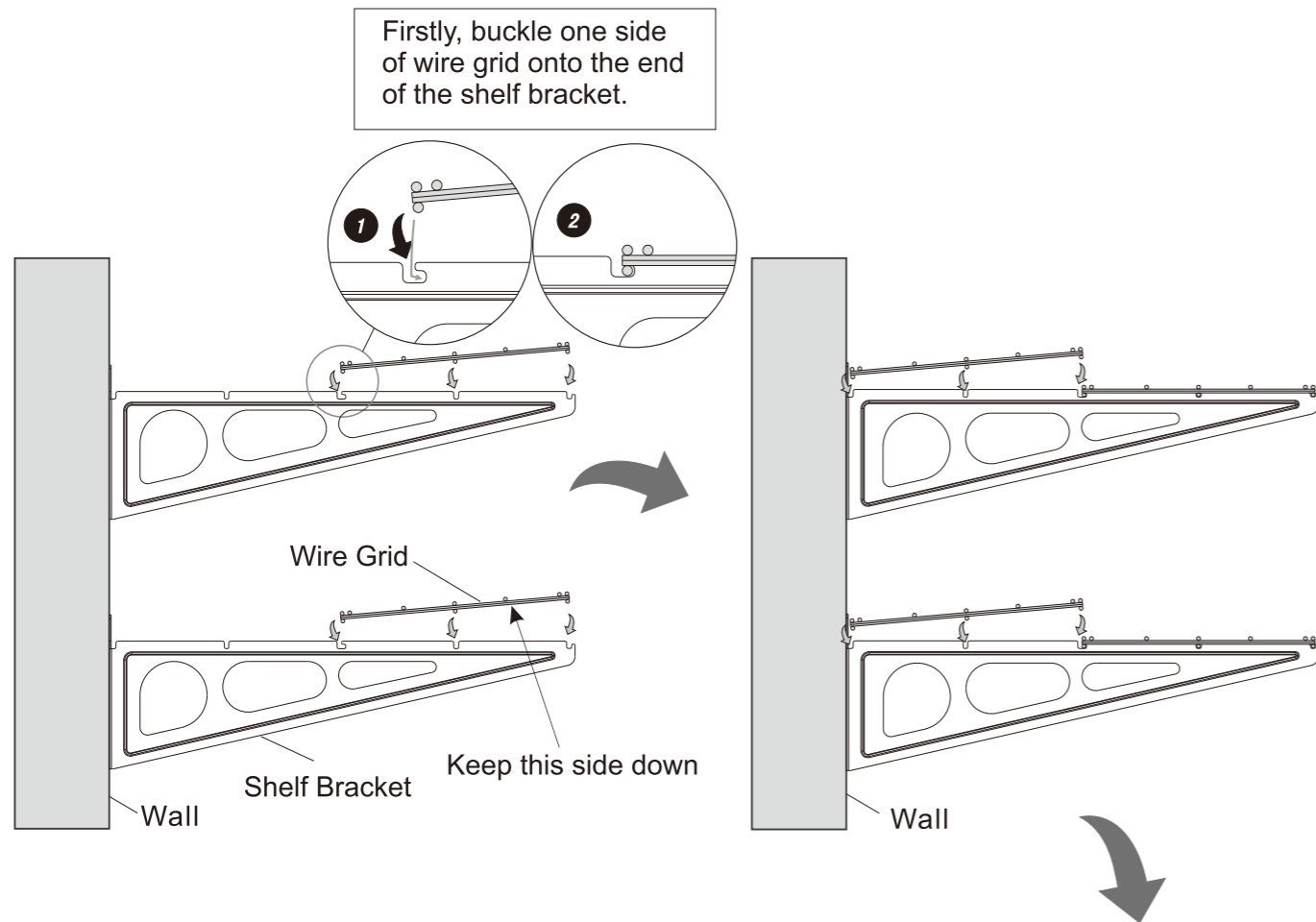

2. Tighten the wire grid and shelf brackets with the velcros at the position shown in the figure.

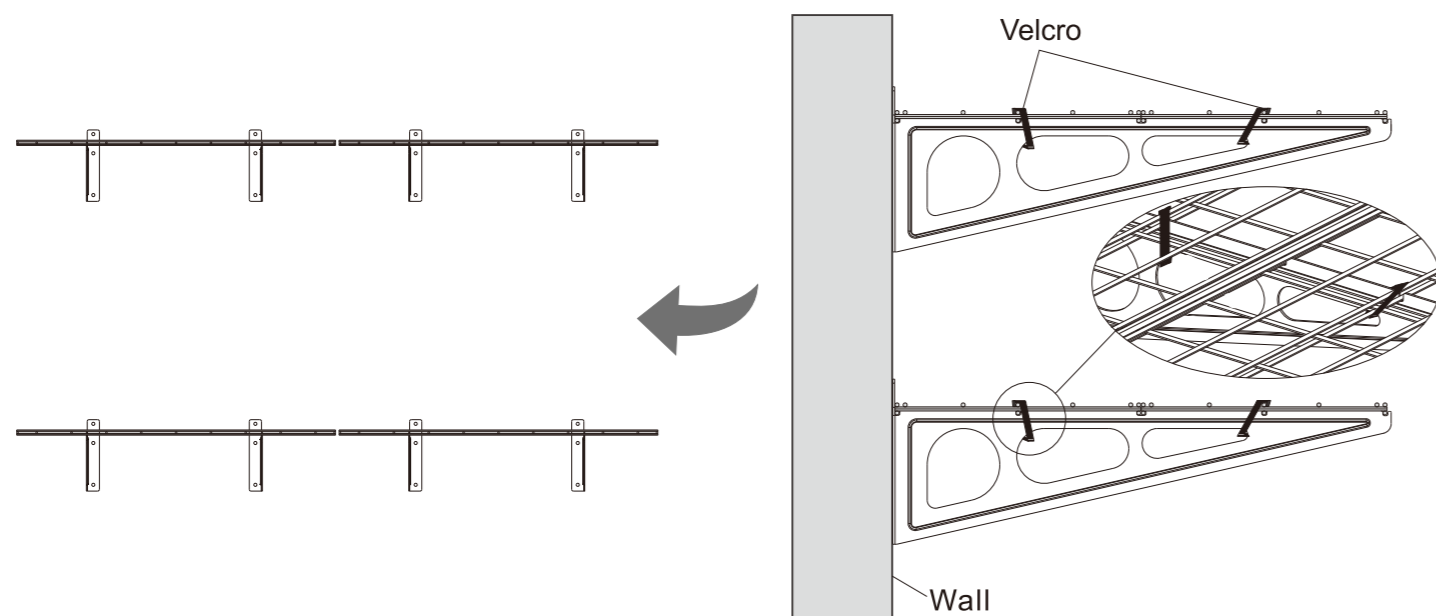

⚠ CAUTION

This product contains small items that could be a choking hazard if swallowed. Keep these items away from young children.

- Make sure these instructions are read and completely understood before attempting installation. If you are unsure of any part of this installation, please contact a professional installer for assistance.

- The wall must be capable of supporting the combined weight of the garage rack and your stuff. Otherwise, the structure and weight capacity of the ceiling must be reinforced.

- Proper tools must be used. A minimum of two people are required for this installation. Failure to install properly can result in property damage or serious injury.

- Check joint parts every two months, making sure the screws have not loosened.

- This product is designed to be installed on a wooden wall or solid concrete ceiling. Before installation, make sure that the weight capacity of the wall will support the combined load of the rack and your stuff. Never exceed the maximum load capacity of the product 198 lbs (90 kg), or else it may result in product damage or physical injury.

Note: This product is intended for indoor use only. Use of this product outdoors could lead to product damage or physical injury.

FLEXIMOUNTS

ADDRESS: 4569 Las Positas Rd. Suite A, Livermore, CA 94551

ADDRESS: 4290 Concorde Road, Memphis, TN 38118

TEL: 1-855-421-2808

Facebook: Fleximounts

Twitter: Fleximounts

Website: www.fleximounts.com

