

BIN WAREHOUSE

FOR STORAGE TOTES - ASSEMBLY INSTRUCTIONS

TOOLS REQUIRED

1. Powered Screwdriver with #2 Phillips-Head Tip



PARTS LIST

1. (8) Horizontal Crossbars
2. (4) Center Verticals
3. (2) Left & Right Rear Corner Verticals
4. (1) Left Front Corner Vertical
5. (1) Right Front Corner Vertical
6. (4) Wall Mount Flanges
7. (4) Wall Mount Extension Tubes
8. (12) Horizontal Sliderrails

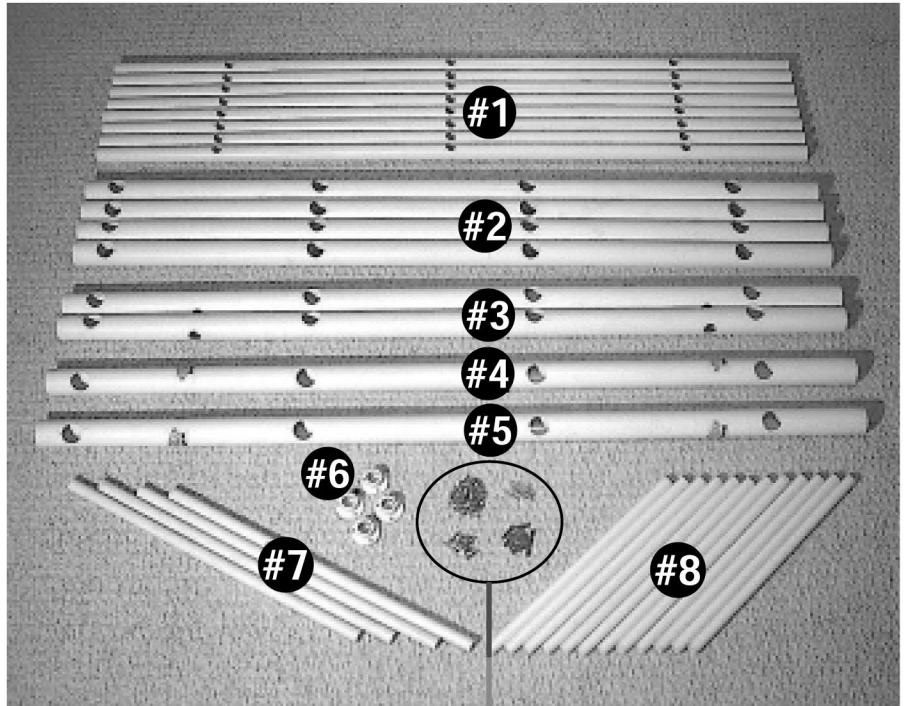

FASTENER LIST

1. (60) #08 x 3/4" Fastening Screws
2. (08) #08 x 1-1/2" Wall Mount Extension Tube Fastening Screws
3. (12) #10 x 1-1/4" Wall Mount Flange Screws
4. (12) Plastic Wall Anchors

NOTE:

Separate All Parts into Groups (as shown) and Familiarize. Read All Instructions Before Beginning Assembly

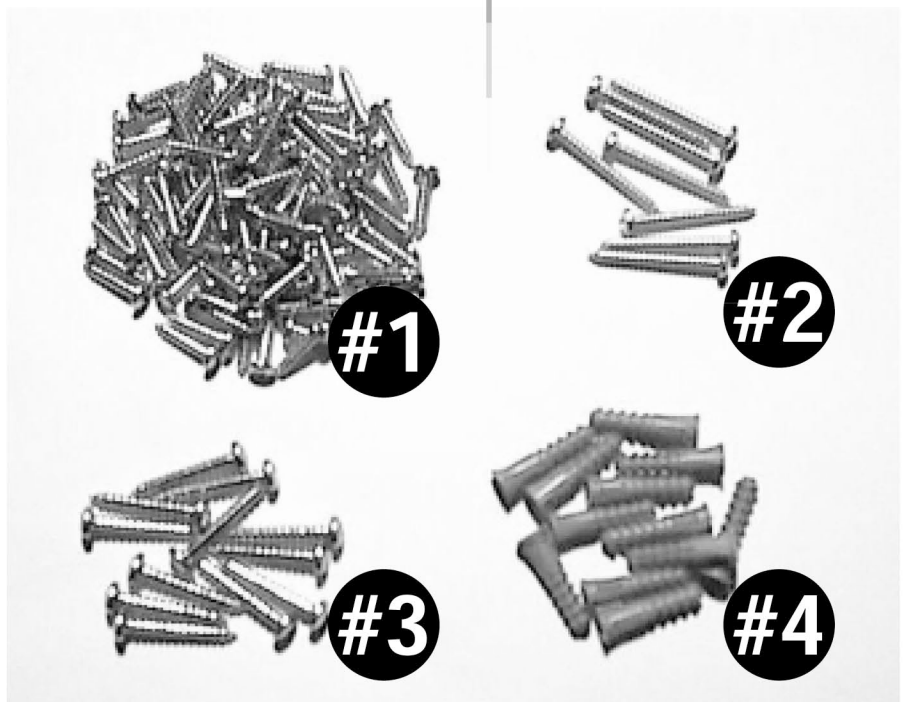

IMPORTANT: Do not install any fasteners until instructed!

Numbers in **BOLD** indicate item number from Parts/Fastener Lists.

FRONT GRID ASSEMBLY

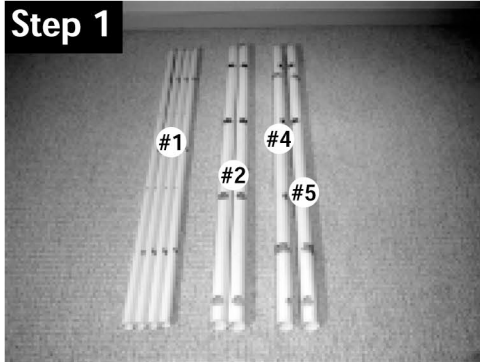

Step 1

Parts Needed:
4 of #1 2 of #2
1 of #4 1 of #5

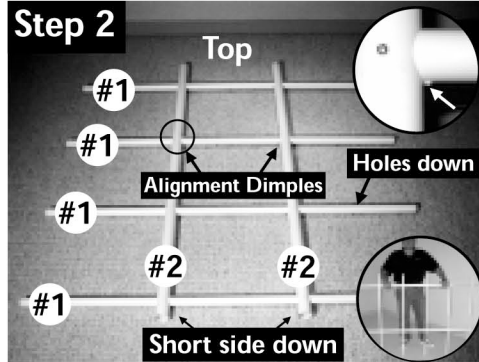

Step 2

4 Horizontal Crossbars (#1) inserted through
2 Center Verticals (#2)
*Tip: When installing second Center Vertical, stand
assembly with Horizontal Crossbars placed on floor
and push down second Center Vertical to Alignment
Dimples.*

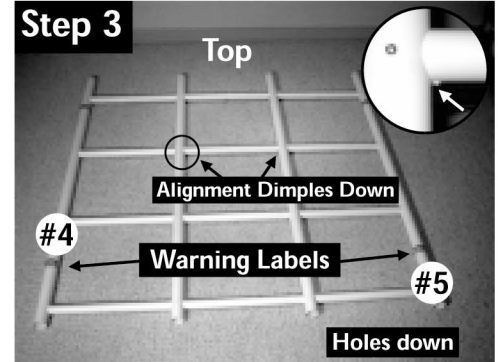

Step 3

1 Left Front Corner Vertical (#4) and 1 Right Front
Corner Vertical (#5) Placed on Horizontal
Crossbars

REAR GRID ASSEMBLY

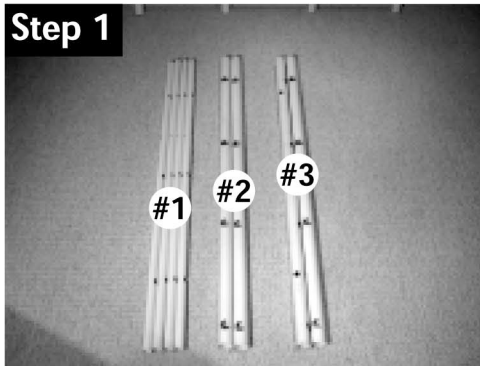

Step 1

Parts Needed:
4 of #1 2 of #2
2 of #3

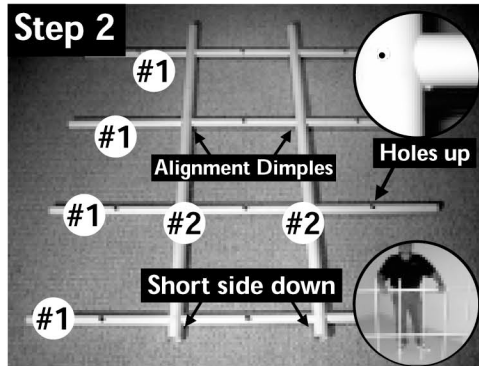

Step 2

4 Horizontal Crossbars (#1) inserted through
2 Center Verticals (#2)
*Tip: When installing second Center Vertical, stand
assembly with Horizontal Crossbars placed on floor
and push down second Center Vertical to Alignment
Dimples.*

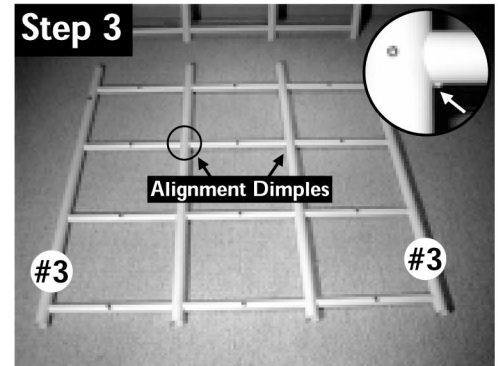

Step 3

2 Left and Right Rear Corner Bars (#3)
Placed on Horizontal Crossbars

SLIDERAIL ASSEMBLY

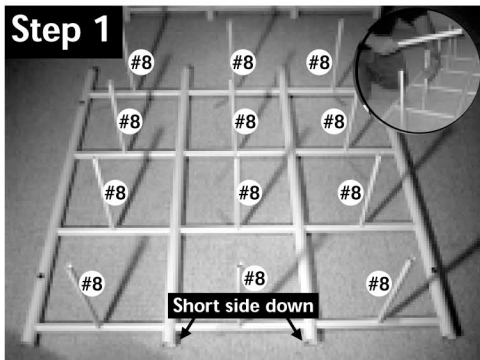

Step 1

12 Horizontal Sliderails (#8) inserted in Rear Grid
*Tip: If Necessary, Tap Horizontal Slide Rails to be
sure Slide Rails are Fully Inserted*

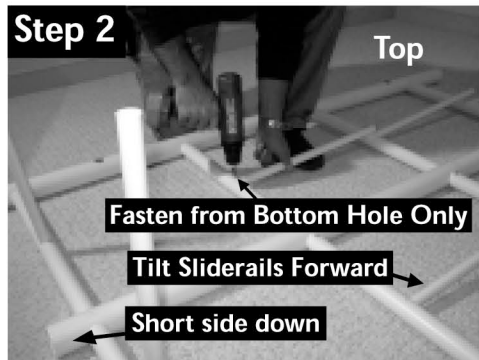

Step 2

Fastening Horizontal Sliderails (#8) in Rear Grid
using 12 - #08 x 3/4" Fastening Screws (#1)
Note: Start at top row and work down.
Use only one fastener - bottom hole only

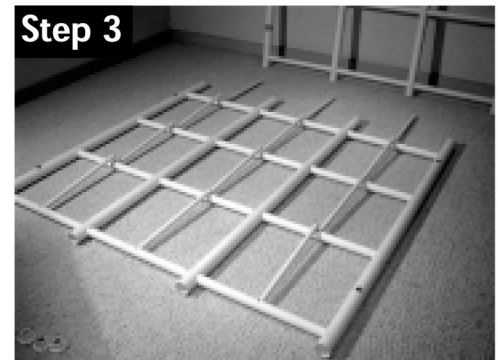

Step 3

All Horizontal Sliderails fastened to Rear Grid
Note: Fastener in Bottom Hole Only

IMPORTANT: Do not install any fasteners until instructed!

JOINING FRONT TO REAR GRID

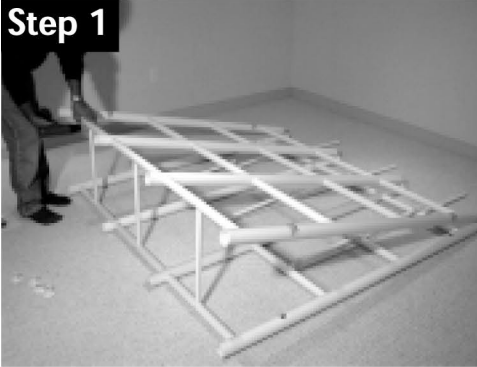

Step 1
Insert Bottom Sliderails (#8) into Front Grid Assembly and fasten (*making sure fully inserted*) using 3- #08 x 3/4" Fastening Screws (#1)
Note: Fasteners in Bottom Hole Only

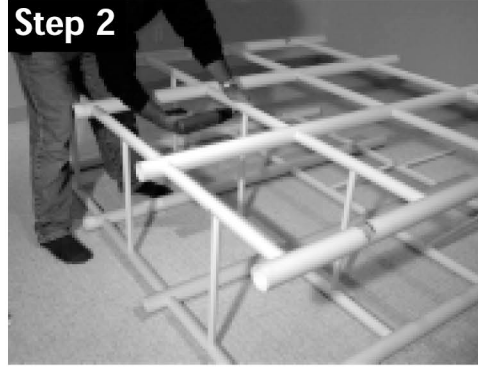

Step 2
Insert and fasten next 3 rows of Sliderail to Front Grid using 9 - #08 x 3/4" Fastening Screws (#1)
Note: Fasteners in Bottom Hole Only



Step 3
Turn unit upright and place firmly against wall where unit is to be mounted.
Short Side Down

FASTENING VERTICALS & WALL MOUNT TUBES

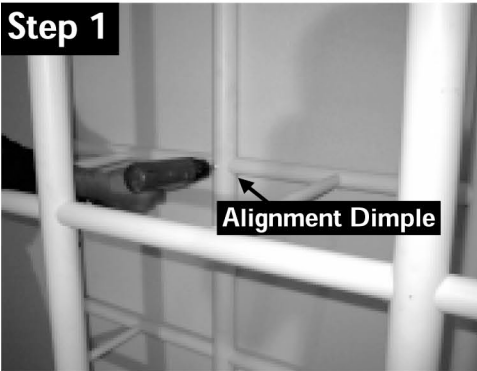

Step 1
Fasten all Verticals to Horizontals. Make sure all joints are pressed firmly together, tight and against alignment dimples.
32 - #08 x 3/4" Fastening Screws (#1)
Note: 1 Fastener Per Joint, each grid, Front Side Only



Step 2
Move unit away from wall and insert 4 Wall Mount Extension Tubes (#7) at 4 Locations.
Fasten With 8 - #08 x 1-1/2" Extension Tube Fastening Screws (#2)
Note: 1 Fastener Per Joint Front Side Only

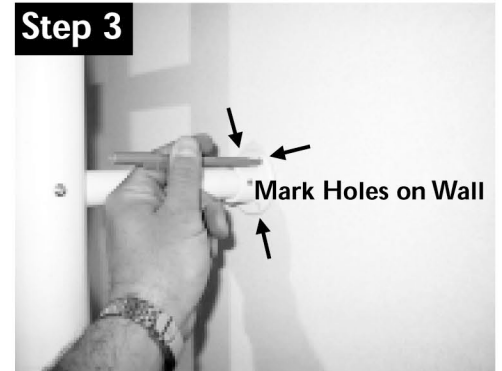

Step 3
Slide Wall Mount Flanges (#6) into Wall Mount Extension Tubes (#7) Place unit against wall where it is to be mounted and mark Wall Flange holes.
Note: Do NOT fasten at this time. Make sure unit remains in position at all 4 locations while marking holes.

FASTENING BIN WAREHOUSE TO WALL



Move unit away from wall and remove Wall Flange from Tube and mount Flange to wall using 12 #10 x 1-1/4" Wall Mount Flange Screws (#3) and Plastic Wall Anchors (#4) if needed.
Note: If mounted into Masonry or Drywall, drill three 1/4" holes to accept Plastic Wall Anchors.



Slide unit back against wall while inserting all 4 Wallmount Extension Tubes (#7) into Wallmount Flanges (#6) and fasten with 4 - #08 x 3/4 Fastening Screws (#1).
Note: 1 Screw per Flange



FINISHED!

Unit must be attached to wall to keep from tipping over!

Congratulations!

We Hope You Enjoy Your Bin Warehouse!