

1

PitStop Furniture
TM

**PITSTOP GT
OFFICE CHAIR**
Parts Assembly
GP1000

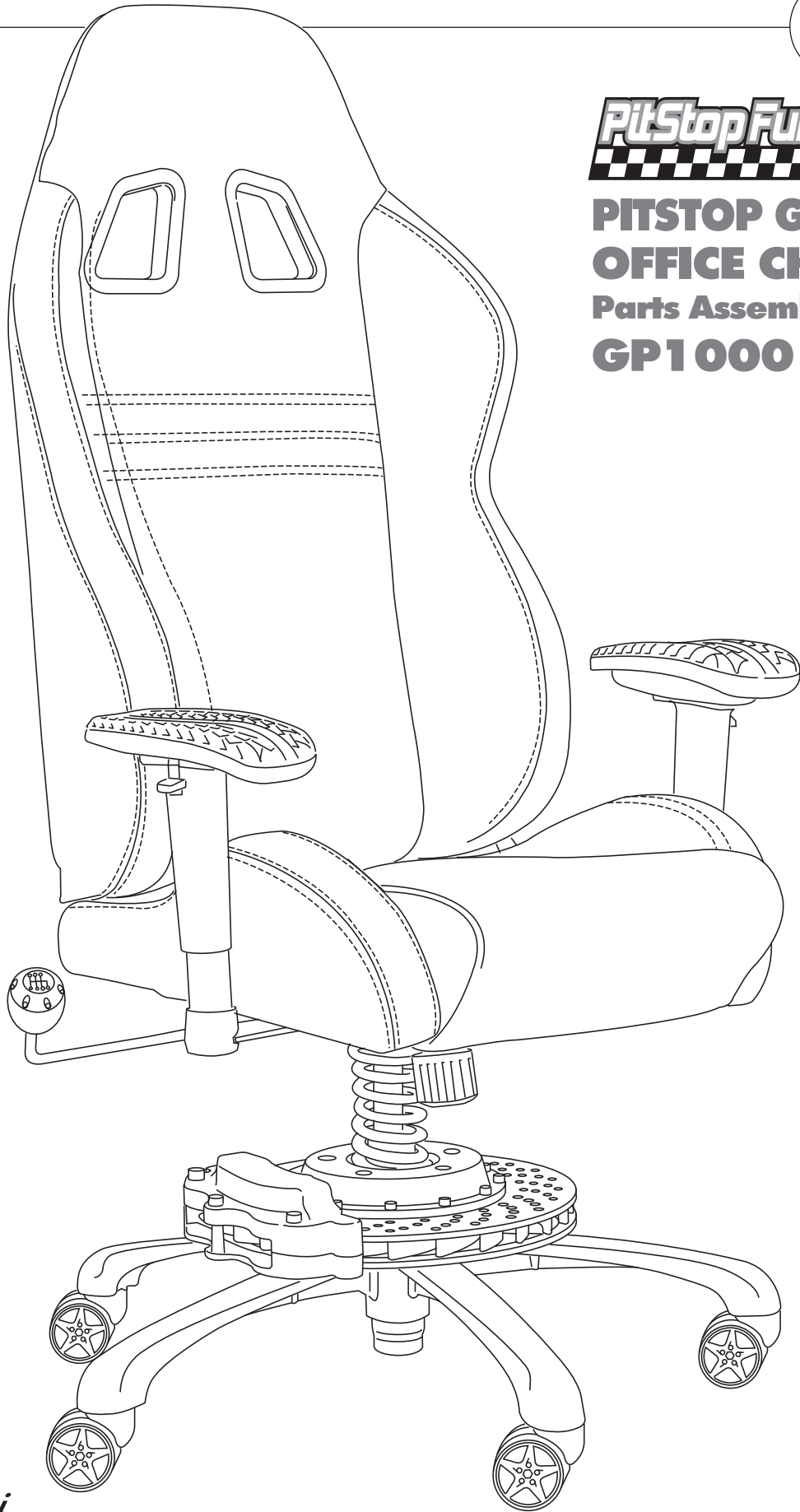

Lentermani

2

**PITSTOP GT
OFFICE CHAIR
Parts Assembly
GP1000**

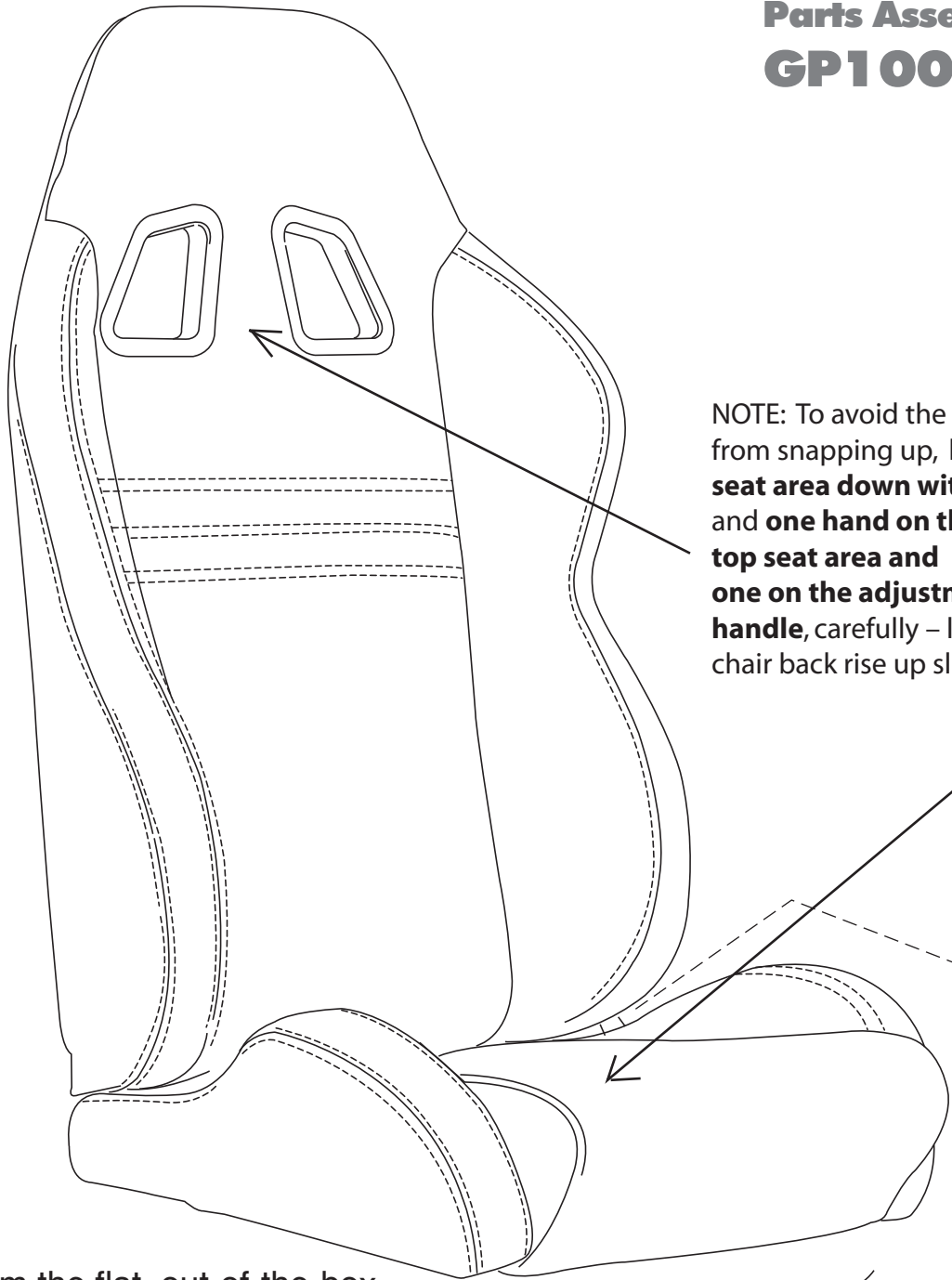

NOTE: To avoid the the chair from snapping up, **hold the seat area down with your knee,** and **one hand on the top seat area and one on the adjustment handle,** carefully – let the chair back rise up slowly.

From the flat, out-of-the-box position – carefully lift up the right seat adjustment handle to an upright position (approximately 90° angle) start your racing chair assembly

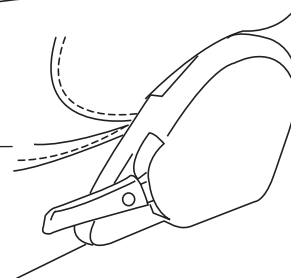

**PITSTOP GT
OFFICE CHAIR
Parts Assembly
GP1000**

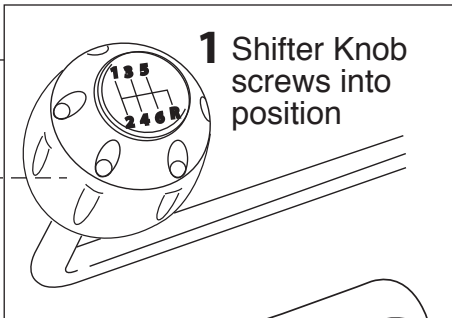

1 Shifter Knob screws into position

3

2 Secure chair base armature to chair bottom with four bolts, lock-washer and washer

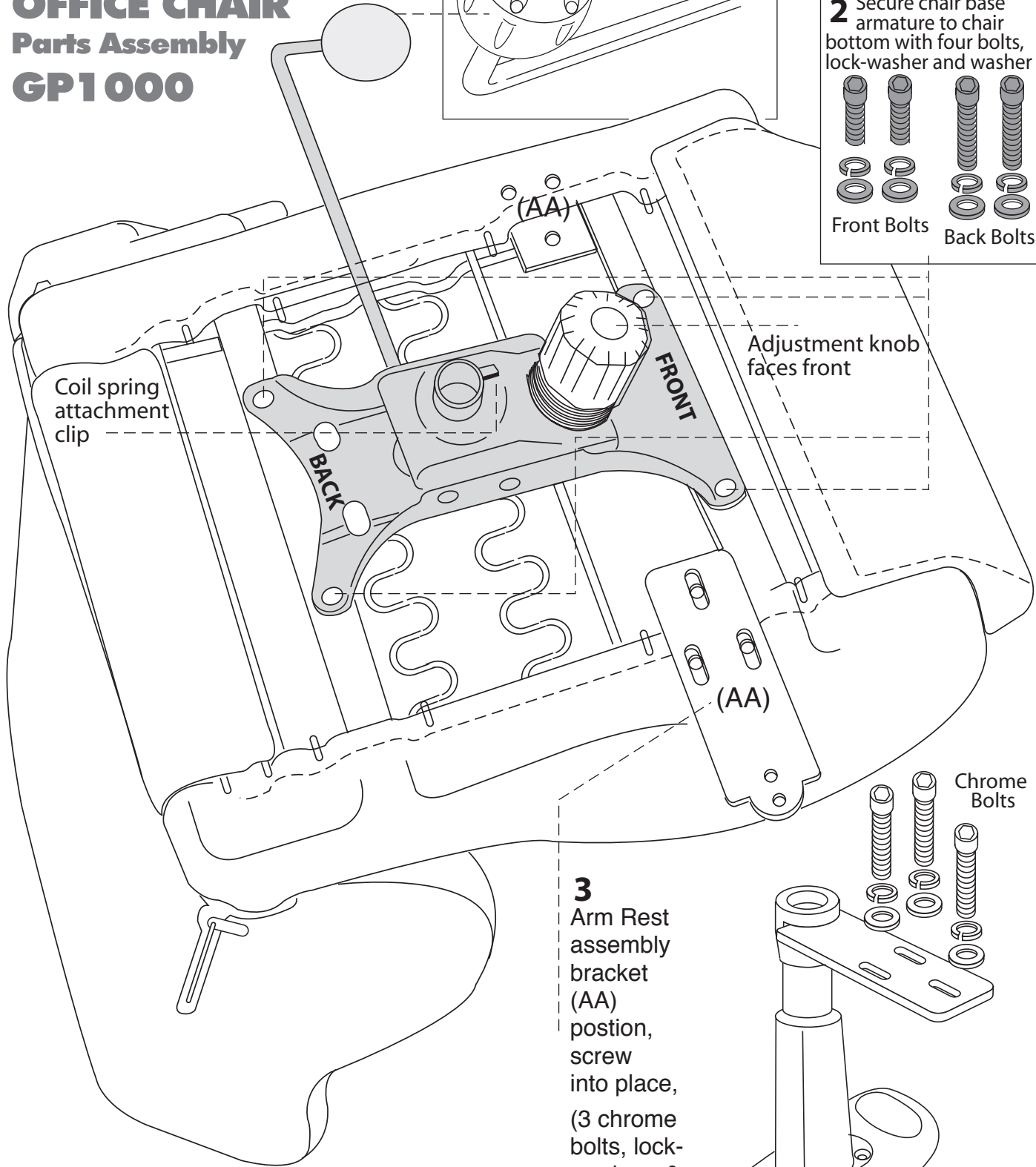
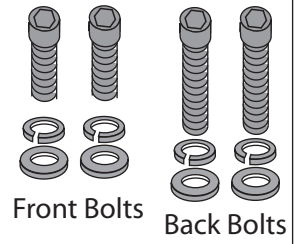

Adjustment knob faces front

Coil spring attachment clip

3 Arm Rest assembly bracket (AA) position, screw into place, (3 chrome bolts, lock-washers & washers)

4

**PITSTOP GT
OFFICE CHAIR
Parts Assembly
GP1000**

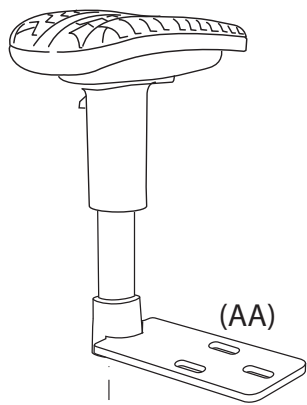

(AA)

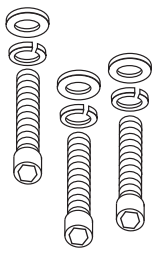
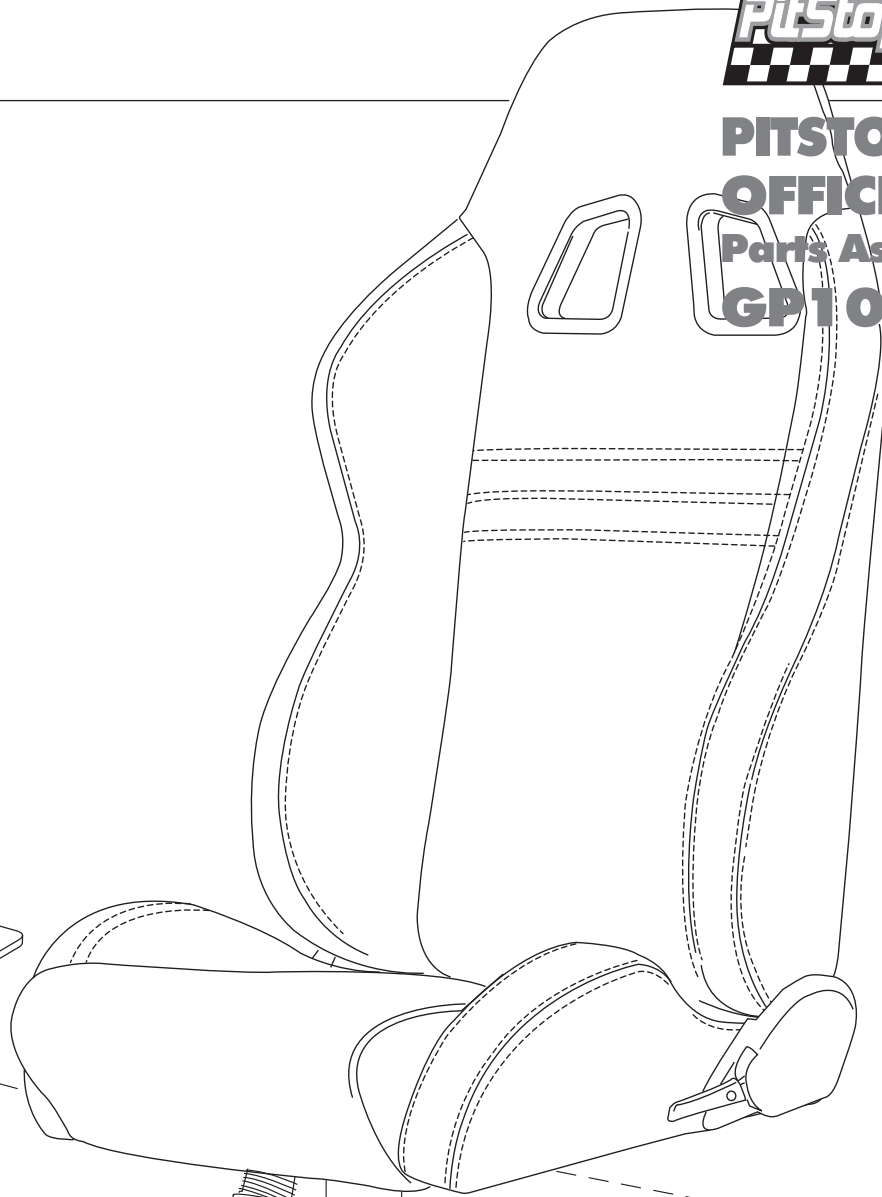

chrome bucket bolts - base

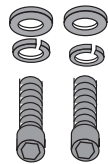

front short bolts - base

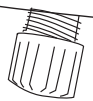

Coil spring attachment clip

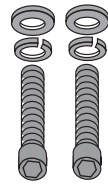

back long bolts - base

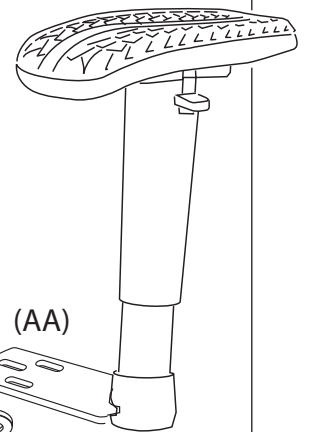
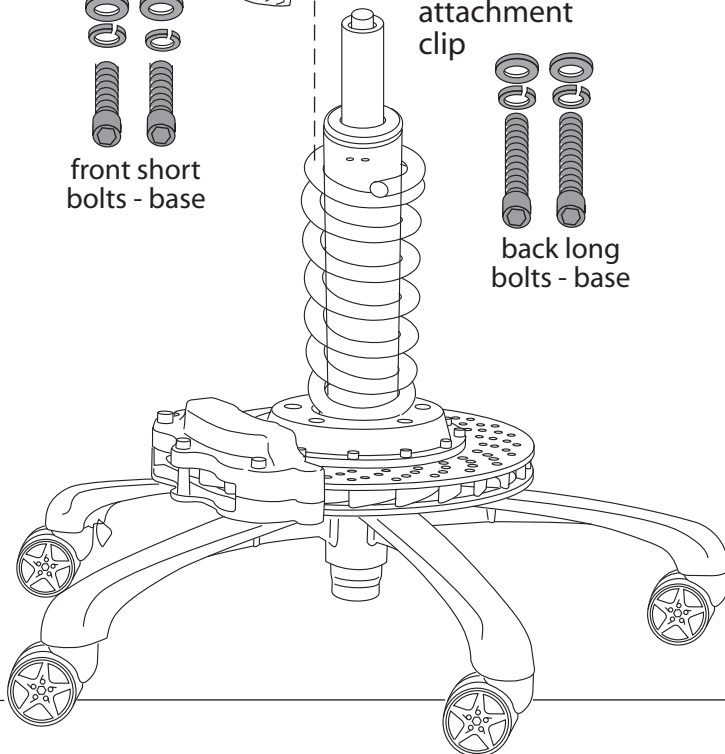

(AA)

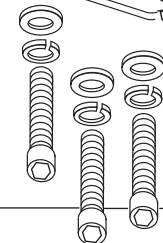

**PITSTOP GT
OFFICE CHAIR
Parts Assembly
GP1000**

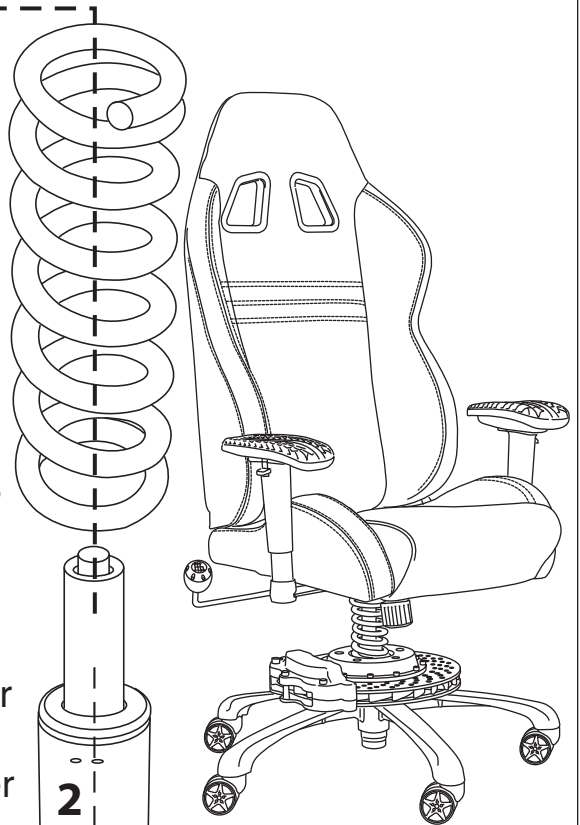
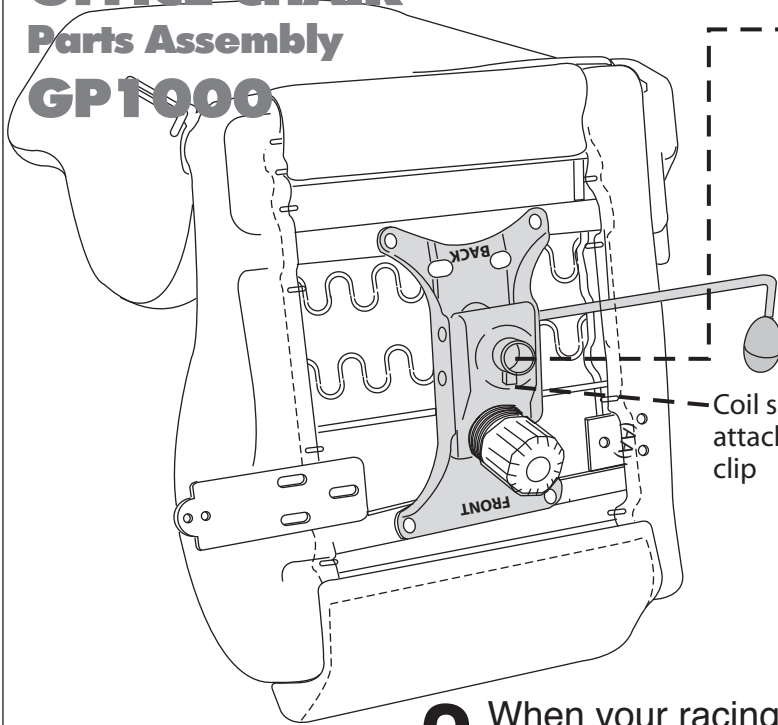

2 When your racing chair is fully assembled – 1-position brake caliper kit over wheel base, 2-insert chair post into wheel base, 3-position suspension coil over post – and insert wheel base unit into chair base socket (snugly).

1 Snap into position the five (5) racing wheels in to chair base

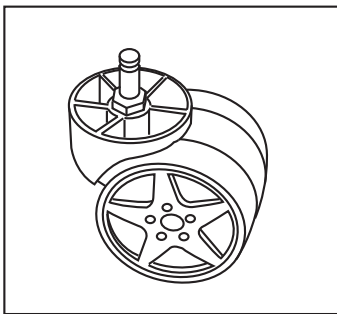

3 Lift chair and wheel base into the up-right position – the chair and wheel base will compress in one complete chair unit.

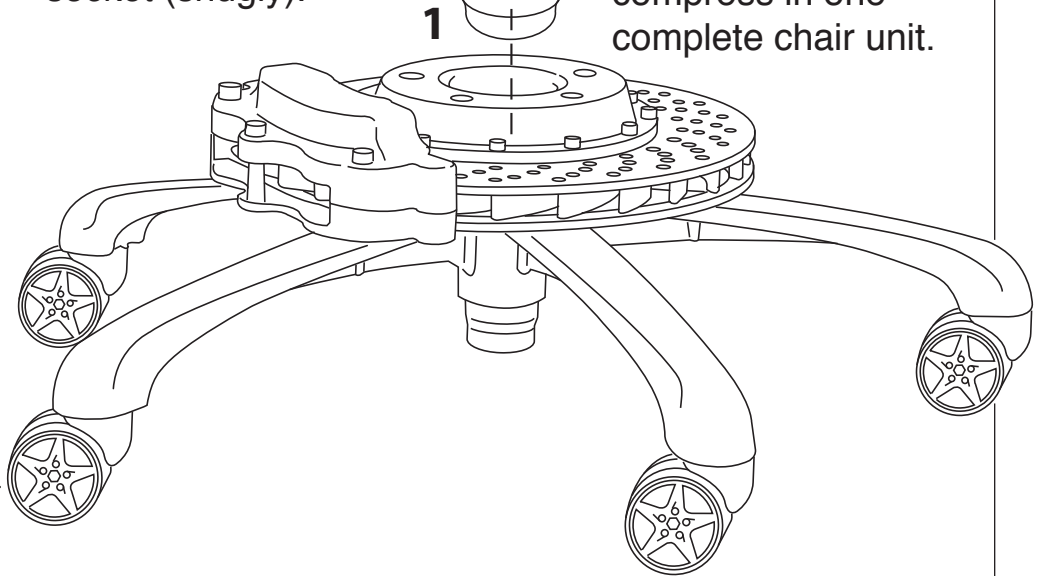

6

PITSTOP GT OFFICE CHAIR Parts Assembly GP1 000

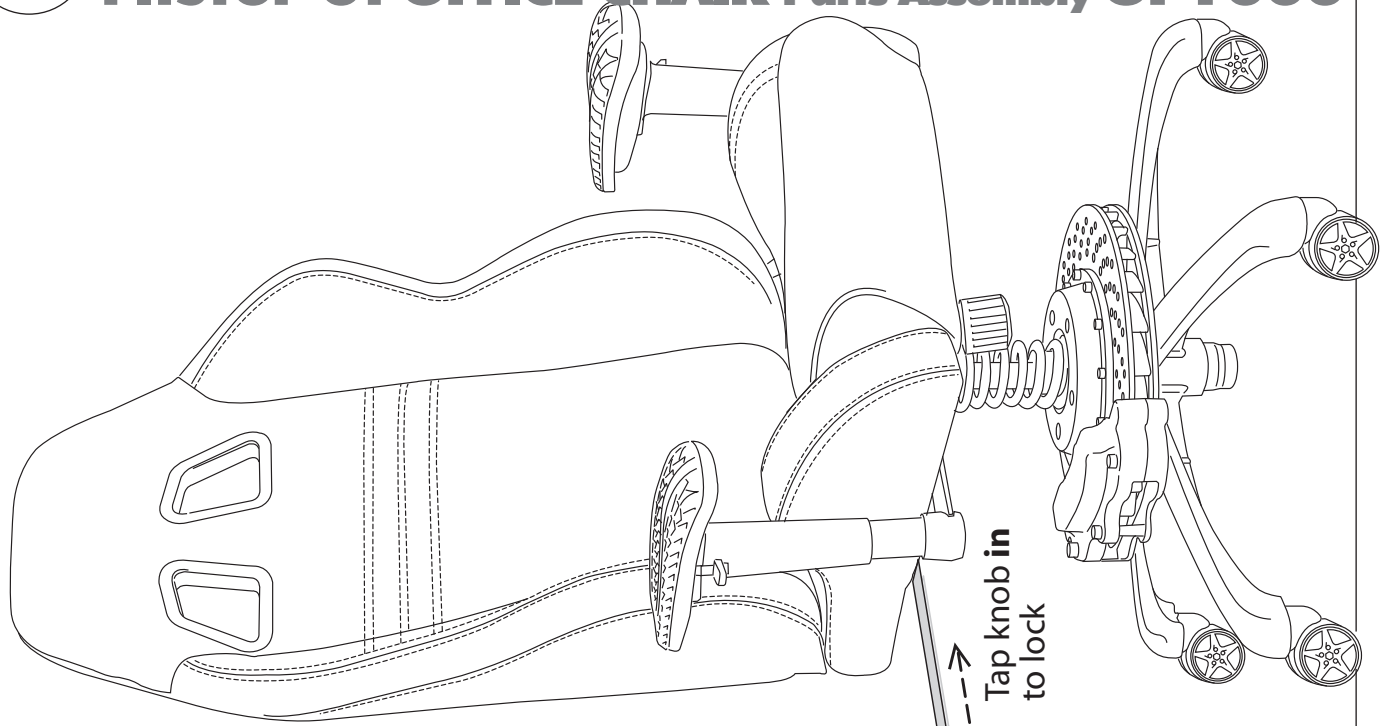

Shifter Knob adjustments –

Tap knob out for rocker position (back and forth)

Tap in to lock chair position

Tap knob in to lock

Tap knob out for rocker

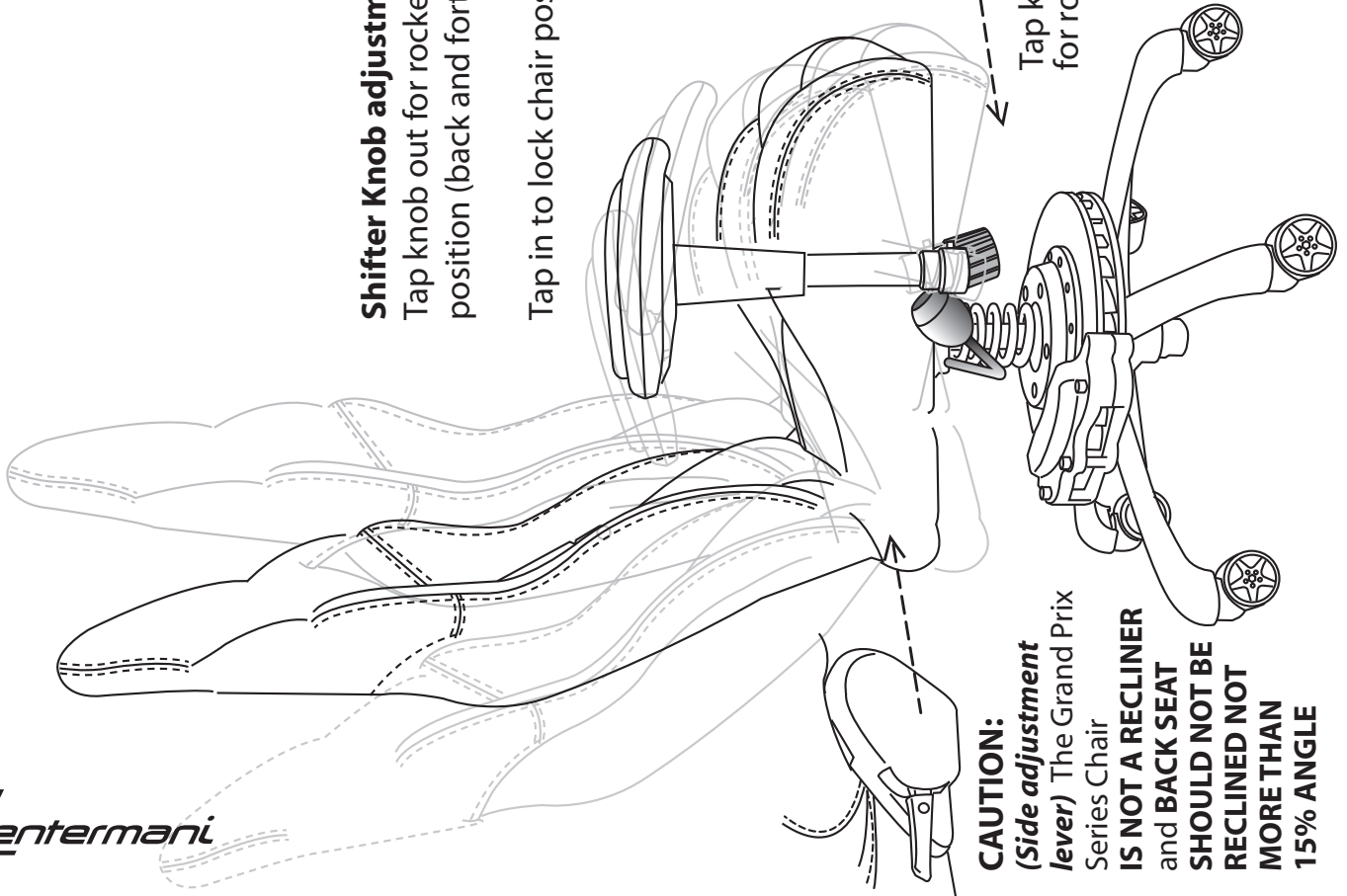

CAUTION:
(Side adjustment lever) The Grand Prix Series Chair **IS NOT A RECLINER** and **BACK SEAT SHOULD NOT BE RECLINED NOT MORE THAN 15% ANGLE**

**PITSTOP GT
OFFICE CHAIR**

Parts Assembly

GP1 000

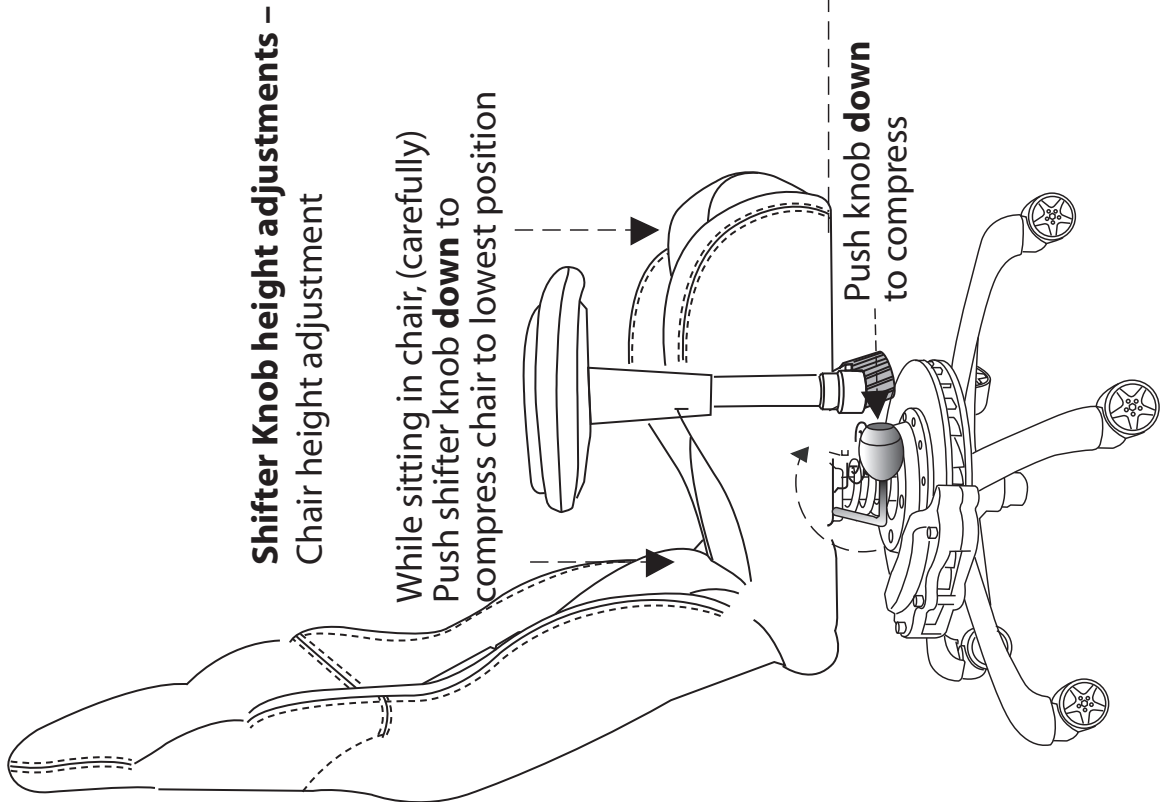
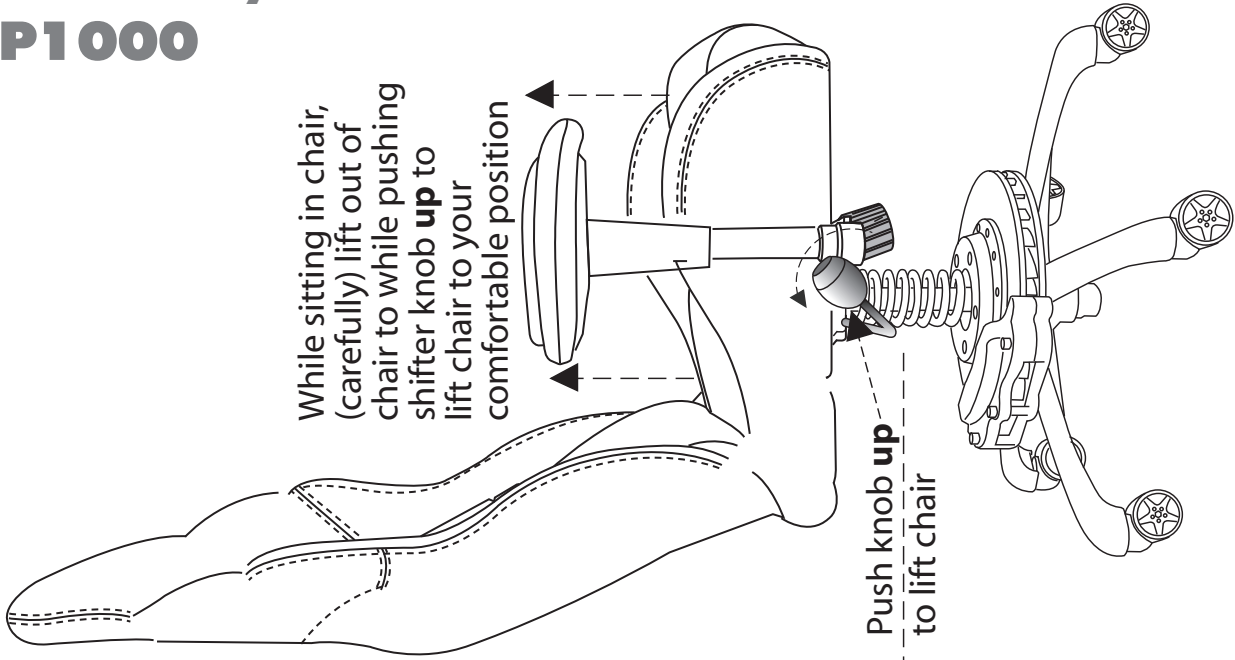

**PITSTOP GT
OFFICE CHAIR
Parts Assembly
GP1000**

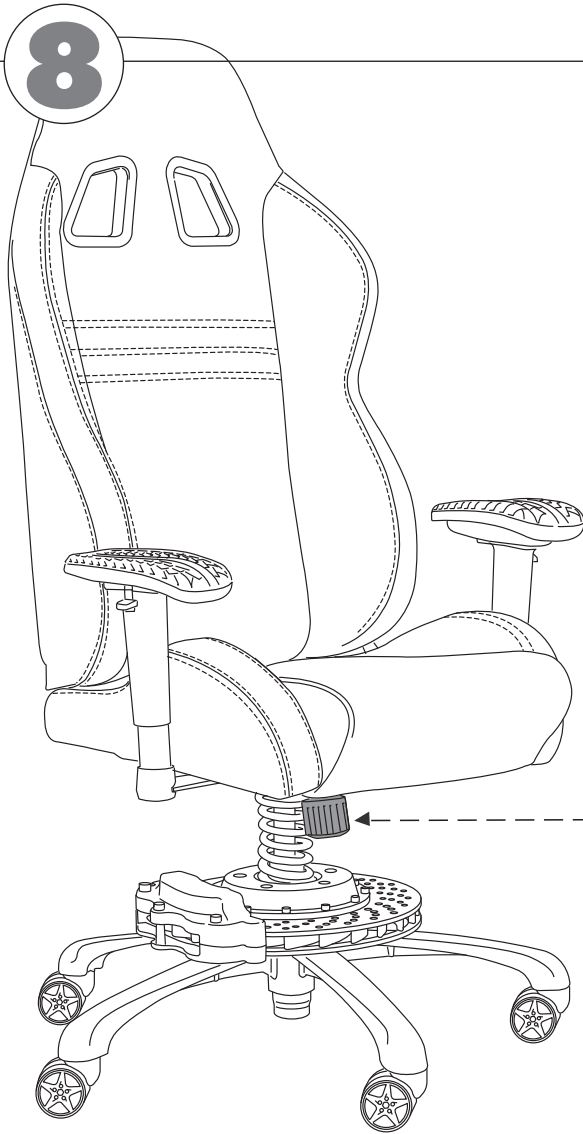

Adjustment knob for
resistance of forward
and back motion of chair

Rotate knob to the desired
resistance level of forward
and back motion of chair

Arm Rest – Three adjustable height settings

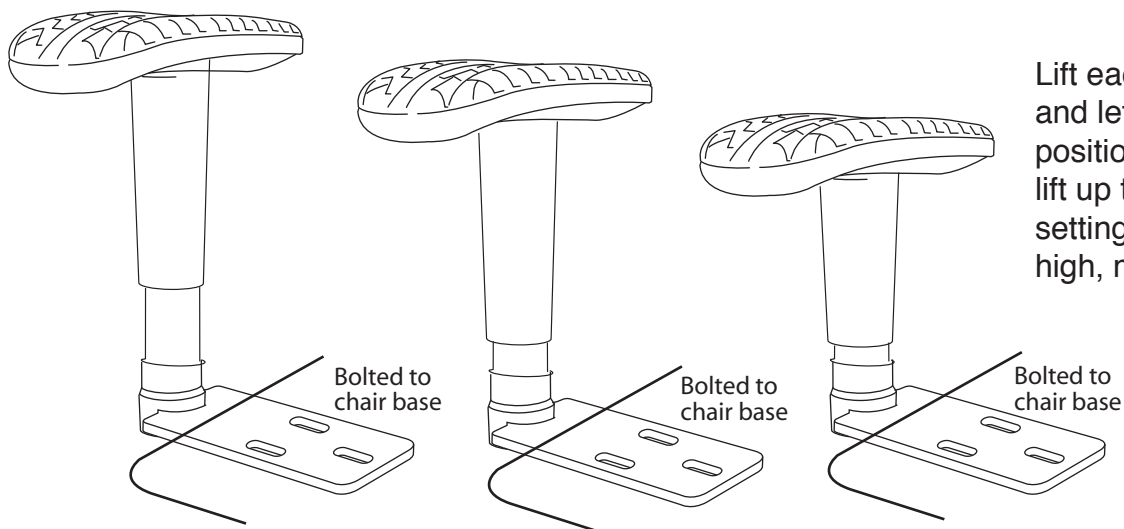

Lift each arm rest up
and let it drop to bottom
position, **carefully**
lift up to desired height
setting (3 settings –
high, medium, low)